

LEASE AREA BREAKUP	
	Area (sqm)
<b>00. COMMON AREAS</b>	
COMMON EXTERNAL PAVEMENT	3,045
COMMON LANDSCAPING	1,375
<b>01. BUILDING</b>	
UNIT 01	286
<b>02. BUILDING</b>	
UNIT 02	498
UNIT 03	245
UNIT 04	249
UNIT 05	249
UNIT 06	250
UNIT 07	276
<b>03. BUILDING</b>	
UNIT 08	192
UNIT 8 CANOPY	516
UNIT 8 EXTERNAL PAVEMENT	776
UNIT 09	71
UNIT 10	71
<b>99. SITE</b>	
SITE AREA	8,097

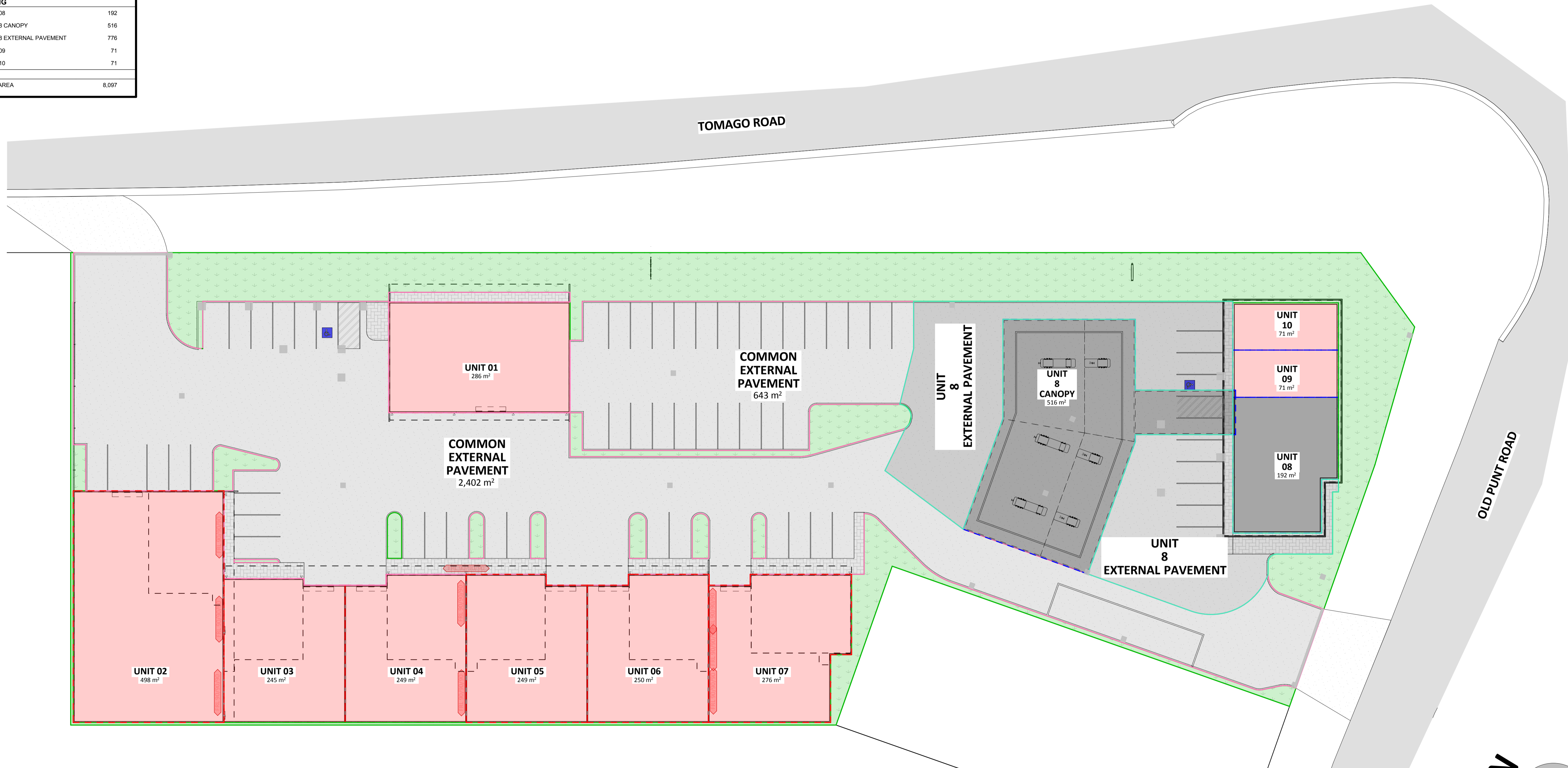

LEASE AREA BREAKUP  
1:250

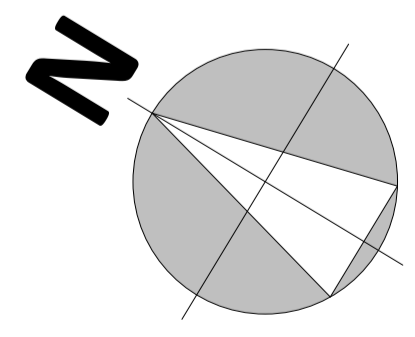

No	AMENDMENTS	DATE	DRAWN	CHKD
2	REVISED FIRE CONCEPT, COMPARTMENT BREAKUP AND PANEL THICKNESSES FOR BUILDING 2	17.8.19	DP	DP
1	ISSUED FOR FURTHER CONSULTANT PLANNING	24.10.18	DP	DP
0	LEASE AREA BREAKUP	29.05.18	DP	DP



**ATB MORTON (NSW) PTY LTD**  
 CIVIL - ENGINEERING - CONSTRUCTION - FITOUT  
 Phone: 02 4961 6822 Fax: 02 4961 4343  
 Email: enquiries@atbmorton.com.au

**© COPYRIGHT: ATB MORTON PTY LTD**  
 - These plans are not to be reproduced entirely or in part without the express written permission of ATB Morton (NSW) Pty Ltd.  
 - Builder to check on site, verify and assume responsibility for all dimensions, setbacks, setbacks and levels.  
 - Do not scale plans. If in doubt contact this office prior to commencement of works.

DRAWN	DP	DATE	26/08/2019
CHECKED	AM	DATE	26/08/2019
APPROVED	FM	DATE	26/08/2019
STATUS		CONTRACT	
INDEX	SHEET No. 11		

CLIENT  
**ATB MORTON GROUP**  
 PROJECT  
**PROPOSED SERVICE CENTRE & INDUSTRIAL UNITS**  
 LOT 1 No. 793 CNR TOMAGO ROAD & OLD PUNT ROAD,  
 TOMAGO, NSW

PROJECT	DOC TYPE	CODE	NUMBER	REV.
1359 - DWG - 203 - 01010			<b>2</b>	
SHEET	SCALE	CONTENT		
A1	1:250, 1:1	LEASE AREA BREAKUP		